

DIY WOODEN BOOK NOOK-SD01

书店往事

Bookshop Memories



Ages 14+

安全警告

- 为了保障您在娱乐时的安全,请在拼装之前阅读说明书。
- 此产品适合14周岁以上的人群,儿童必须在父母指导下组装。
- 在未经授权的情况下擅自改变和修改本产品,将损害您有关本产品的权益。

Safety Warning

- To keep your safe, please read this manual before you start.
- This product is suitable for people over 14 years old, children must assemble under the guidance of their parents.
- Any unauthorized alteration or modification of this product will damage your rights and interests related to this product.

注意事项

- 小心地从板上取下配件,防止零件断裂。断点可以用磨砂棒磨平。
- 不要一次性将木板零件全部拆下来。产品需配合无毒环保胶水组装,胶水黏贴后须静置2小时达到最强固化,黏贴后请勿随意挪动否则前功尽弃,建议先进行黏贴部件后再组装其他接插件以节省等待时间。
- 本产品接插口的松紧程度是由加工工艺,环境的温湿度决定的。接插部位如果是安装过紧,则需用指甲锉刀将接口部位打磨再组装;如果安装过松,则需在组装后加胶水进行固定。
- 儿童在组装时需要成人陪同。
- 说明书上含有重要信息,请予以保留。

Attentions

- Carefully remove the accessories from the board, prevent parts from breaking. The break point can be smoothed with a frosting rod.
- Do not detach all the parts at one time. Glue need be used at some points. After the glue is pasted, leave the product untouched for two hours to ensure a firm paste. To save time, you can do the pasting step first and then assemble the rest of the plugins.
- The tightness of the connector is determined by the processing technology and the temperature and humidity of the environment. If the splicing part is too tight to be installed, You can polish it with a file before assembling it; If the installation is too loose, you can use glue to fix it after assembly.
- Children need to be accompanied by adults when assembling.
- Please keep this manual for future reference.

维护和保养

- 请勿将此产品靠近热源或浸入水中。并使用干净柔软的布清洁此产品。
- 请勿使用擦窗剂、喷雾剂、溶剂、酒精、氨水、研磨剂等化学清洁剂来清洁产品。

Maintenance

- Do not place the product near heat or in water. And use a clean soft cloth to clean the product..
- Do not use the chemical cleaners to clean the product, such as window cleaners, sprays, solvents, alcohol, ammonia, abrasive and so on.

注意:感谢您在本店购买产品。若您拿到包裹,发现零件缺失或损坏,可与您购买的店铺
 客服联系或者联系此售后邮箱:booknook.aftersales@hotmail.com (记得提供您的订
 单编码,您购买的店铺名称以及订单截图。)

Notes: Thank you for purchasing product from our store. If you get the package
 and find parts missing or damaged, you can contact the customer service of the
 store you purchased from, or contact the following after-sales email address:
 booknook.aftersales@hotmail.com (Remember to provide your order number,
 the name of the store you purchased from and a screenshot of your order.)

● 配件 Accessories

 <p>LED 灯 LED Light*1</p>	 <p>触摸线 Touch line*1</p>	 <p>电池盒 Battery box*1</p>	 <p>胶纸 Sticker*1</p>	 <p>磨砂棒 Frosted rod*1</p>
 <p>纸配件 Paper*1</p>	 <p>PVC-1</p>	 <p>PVC-2*2</p>	 <p>咖啡杯 Coffee Cup*1</p>	

● 板材清单 Wood Block List

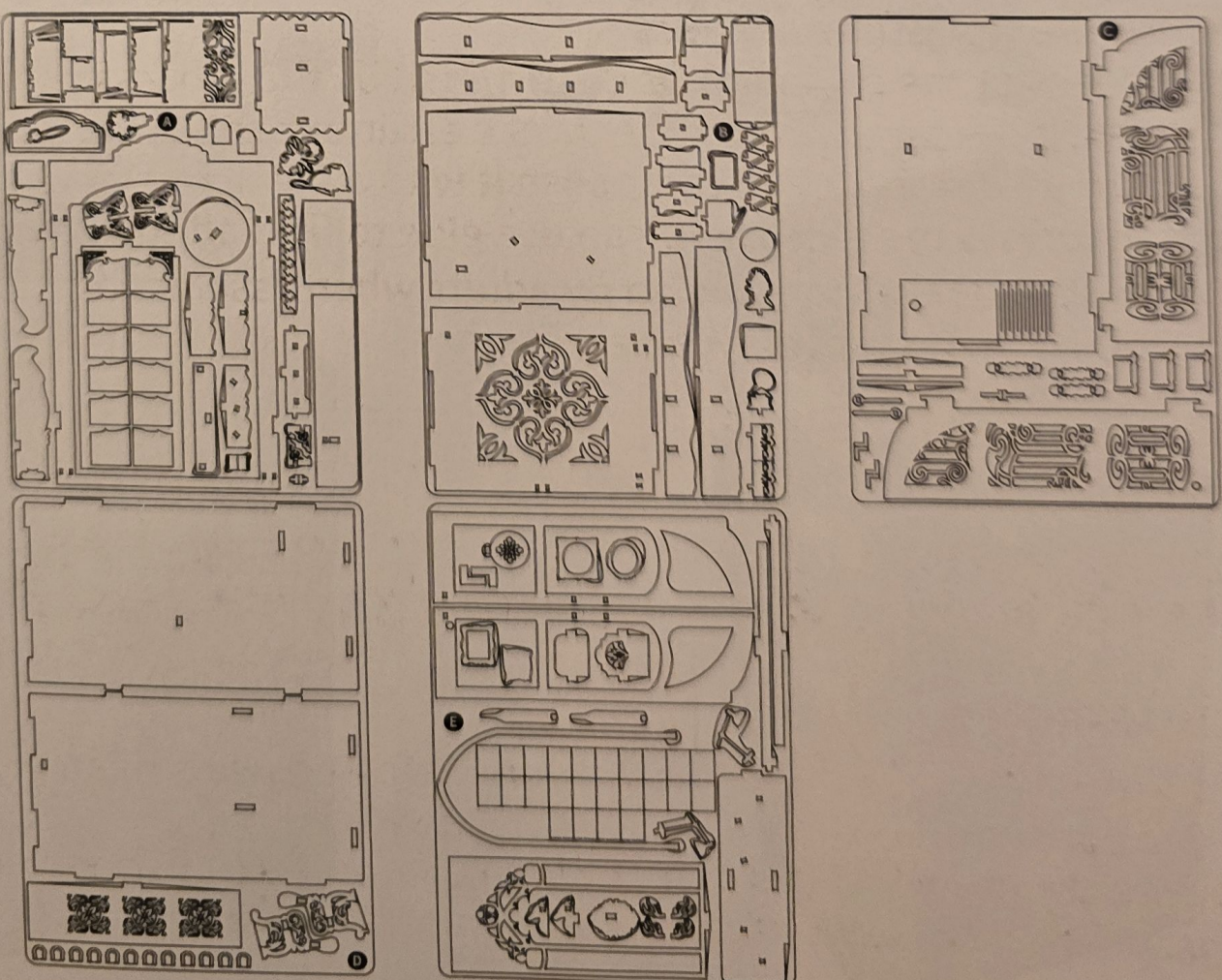

STEP 1

***拼装前请验证LED灯是否可以正常工作。**
Before assembling, please check the LED lights can work properly.

如图所示, 在开始组装之前, 请用电池测试灯具的供电装置是否能正常工作。

测试方法如下:

1. 将LED灯的导线端口和触控感应板的导线端口连接到电池盒的相应端口;
2. 插入两节7号电池(此产品不附带电池);
3. 触摸触控感应板。灯亮, 即可使用; 如果灯不亮, 请重新连接触控线端口, 若仍不能正常工作, 请联系客服更换。

As shown in the picture, before starting to assemble, please test whether the light's power supply unit can work properly. The test method is as follows:

1. Connect the wire port of the LED light and the wire port of the touch sensor panel to the corresponding port of the battery compartment;
2. Insert two AAA batteries (the product does not come with batteries);
3. Touch the touch sensor panel. If the light does not work properly, please reconnect wire port and test again. If still can not work, please contact customer service for replacement.

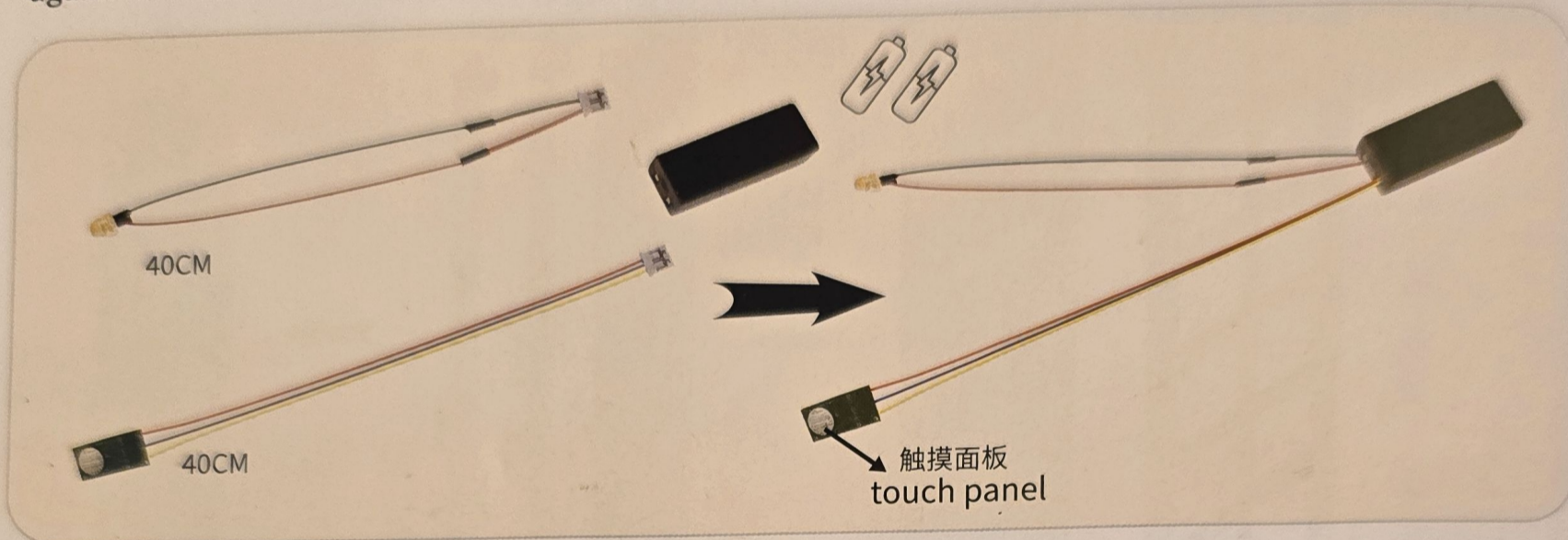

STEP 2

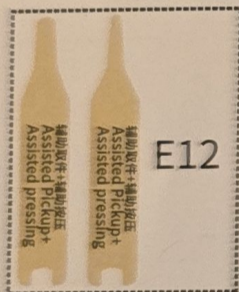

辅助取件+辅助按压
Assisted Pickup+
Assisted pressing

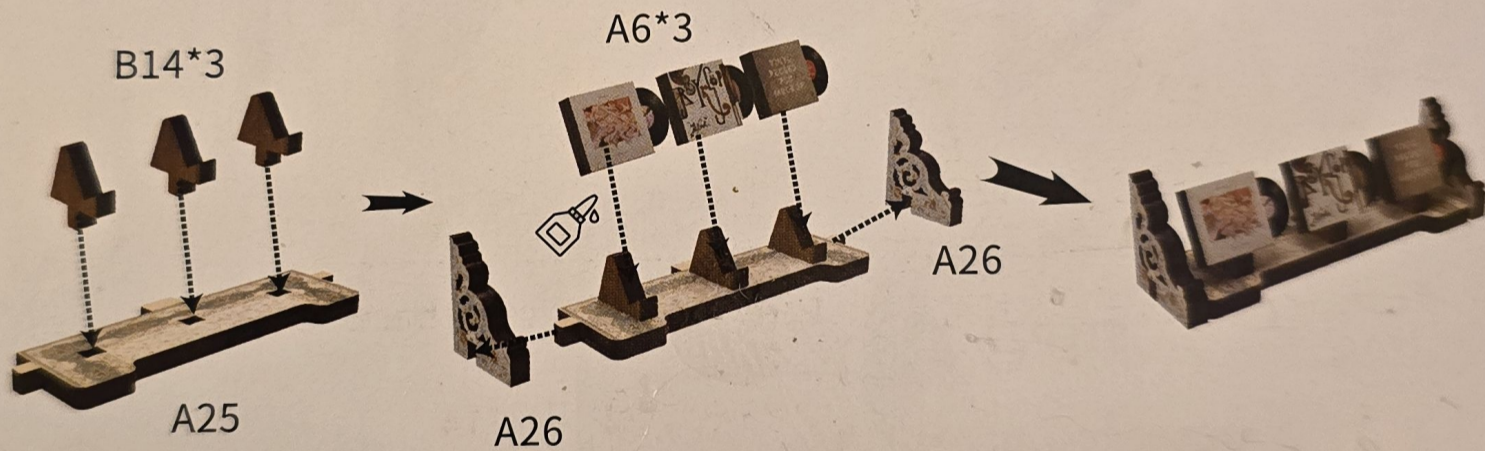

STEP 3

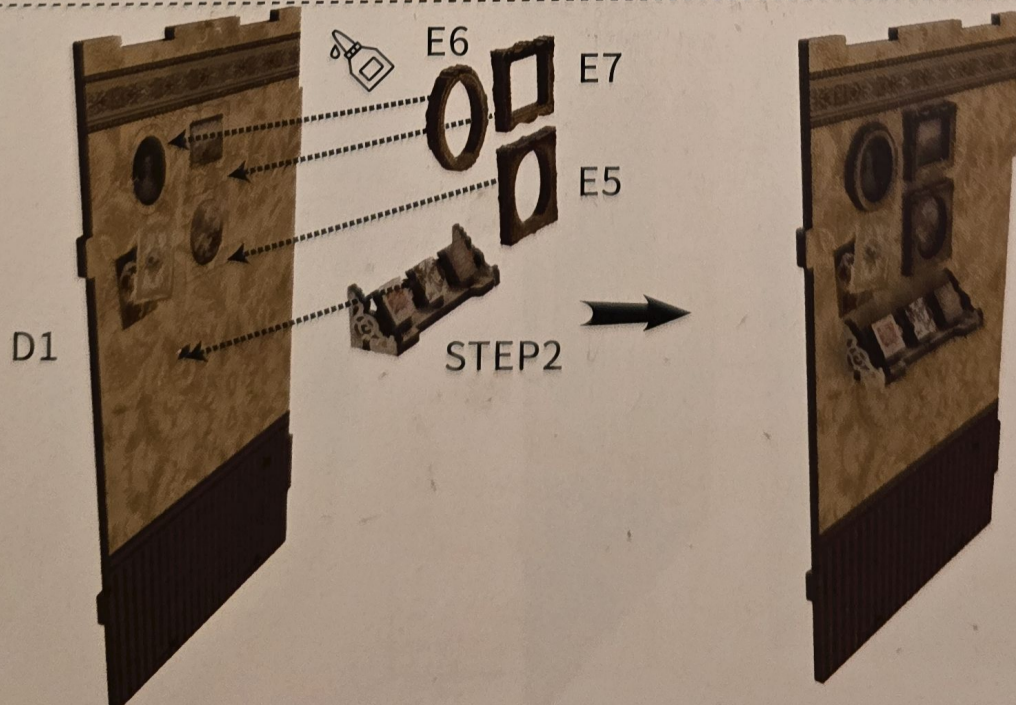

STEP 4

纸配件-2 Paper-2



立体书
Origami X1
Book

把书折成这样。Fold the book like this.

STEP 5

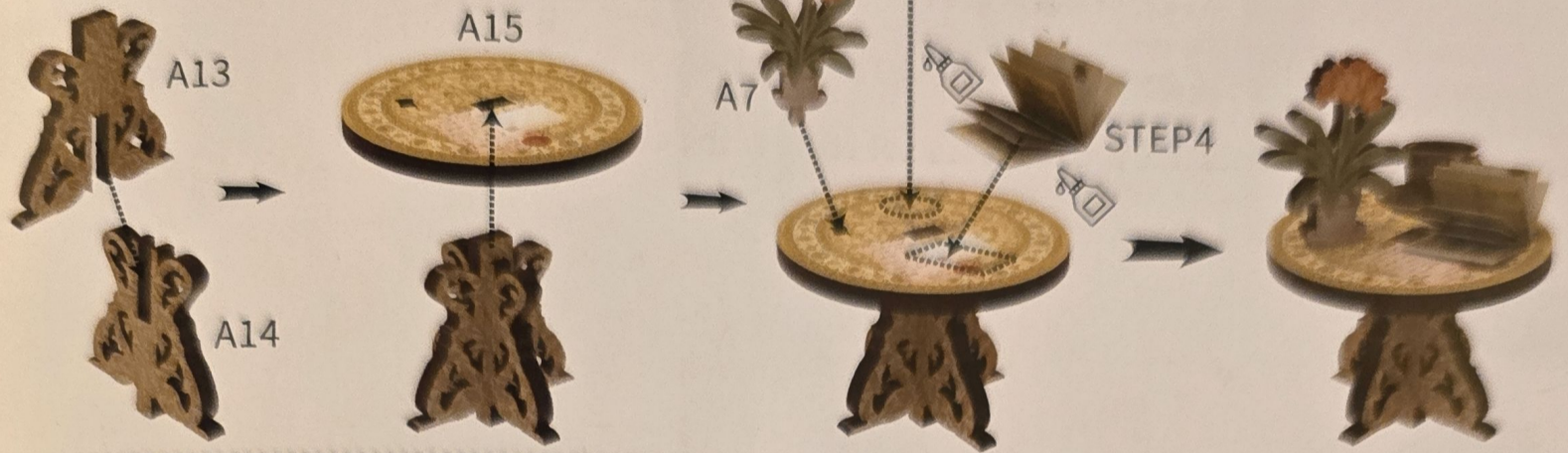

咖啡杯
Coffee Cup*1

STEP 6

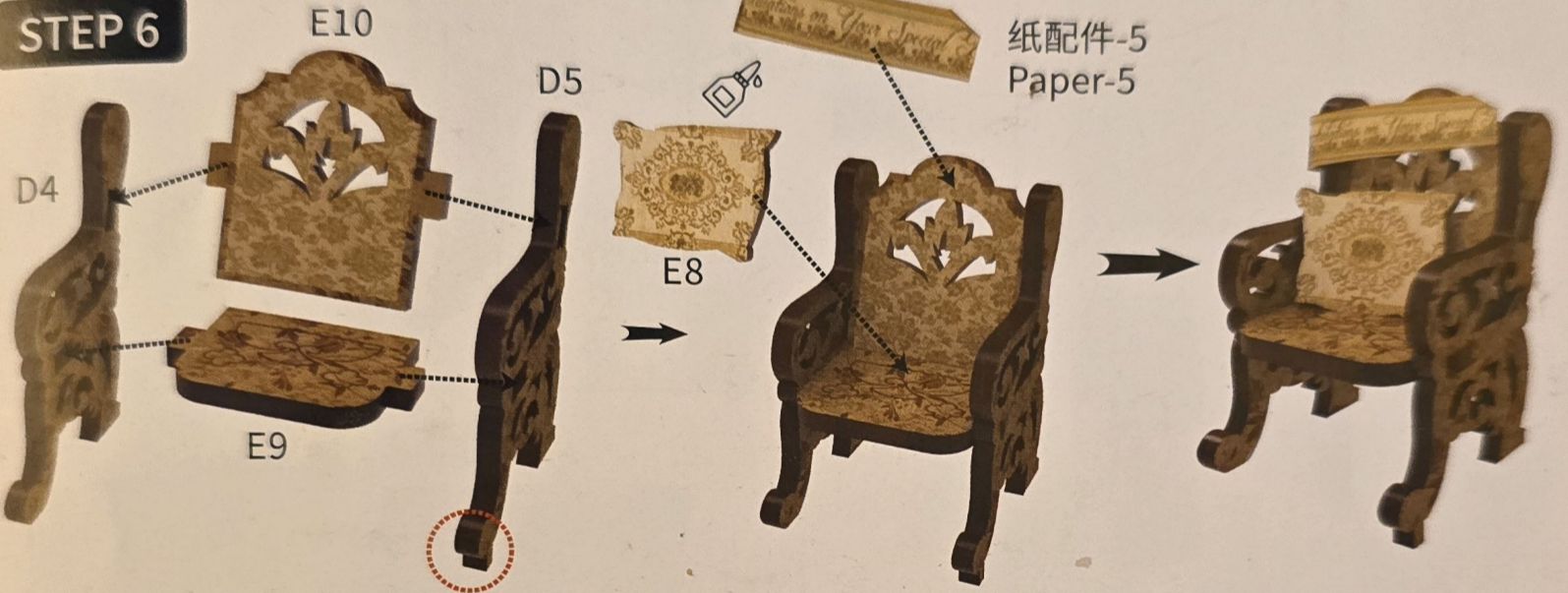

纸配件-5
Paper-5

STEP 7

撕开背胶即可粘贴。Peel off the adhesive backing to paste.

S001-纸配件 Paper



纸配件-1
Paper-1

E14



X24

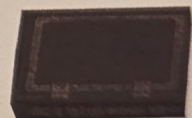

书本*24
Book*24

STEP 8

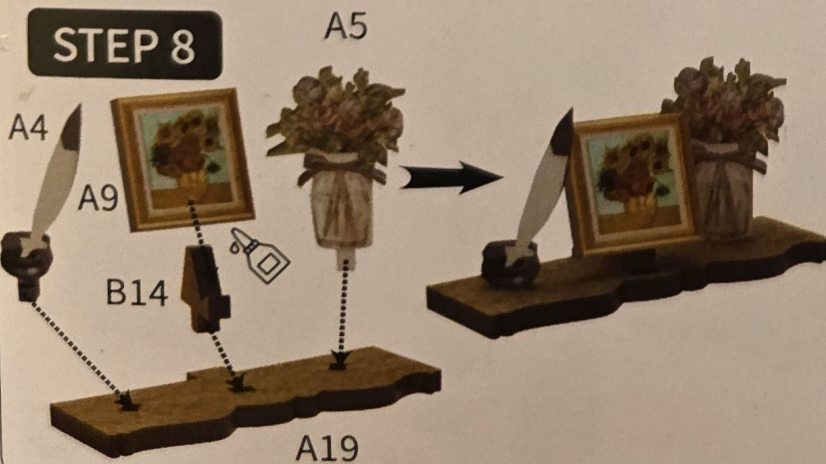

STEP 9

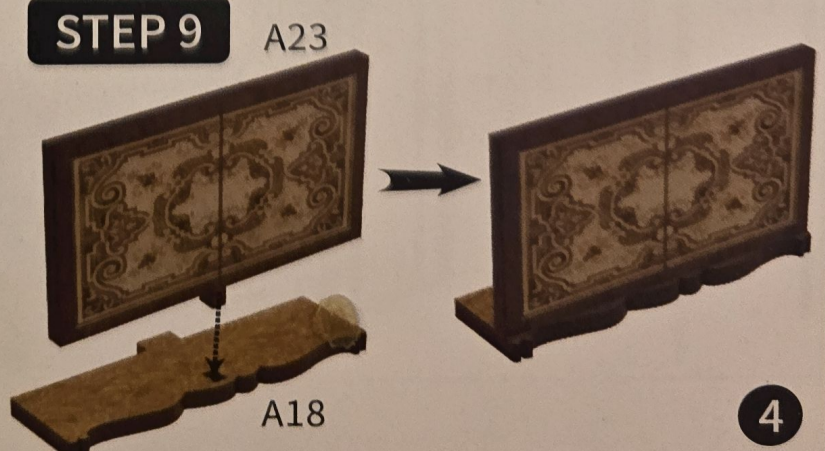

STEP 10

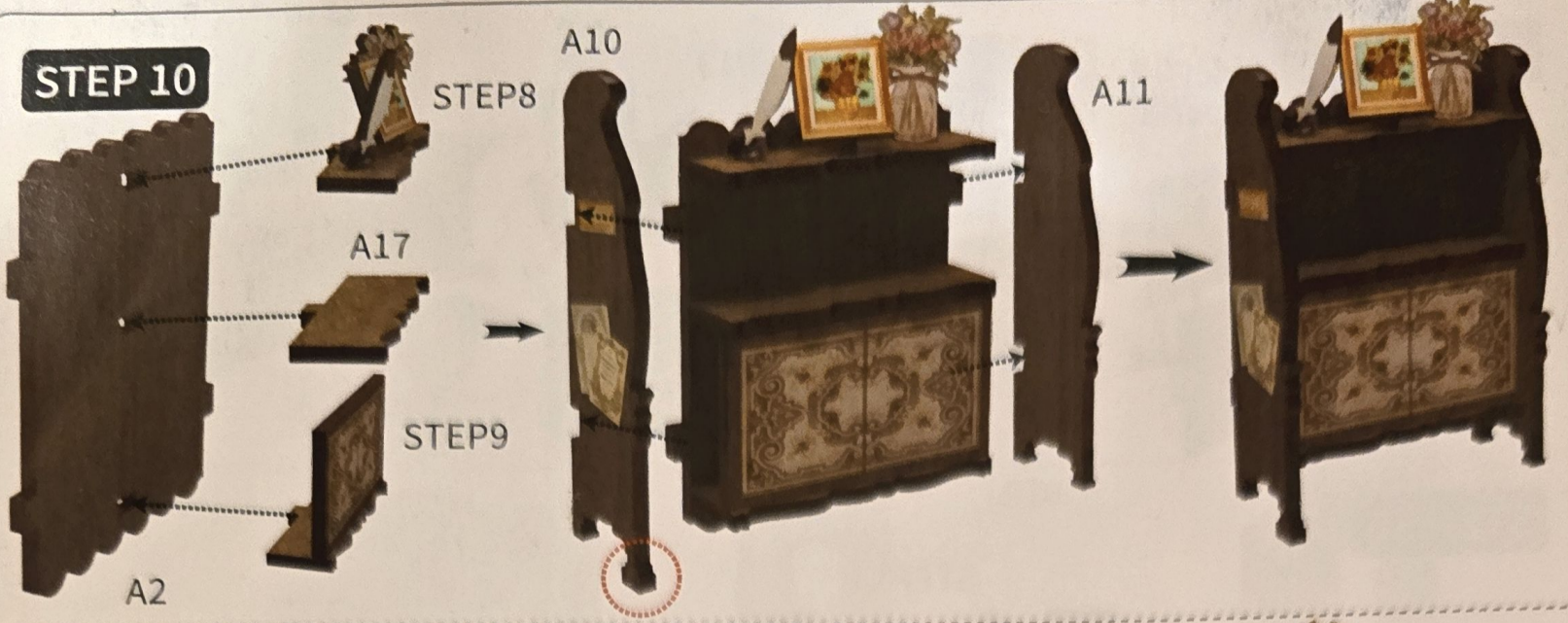

STEP 11



STEP 12



STEP 13

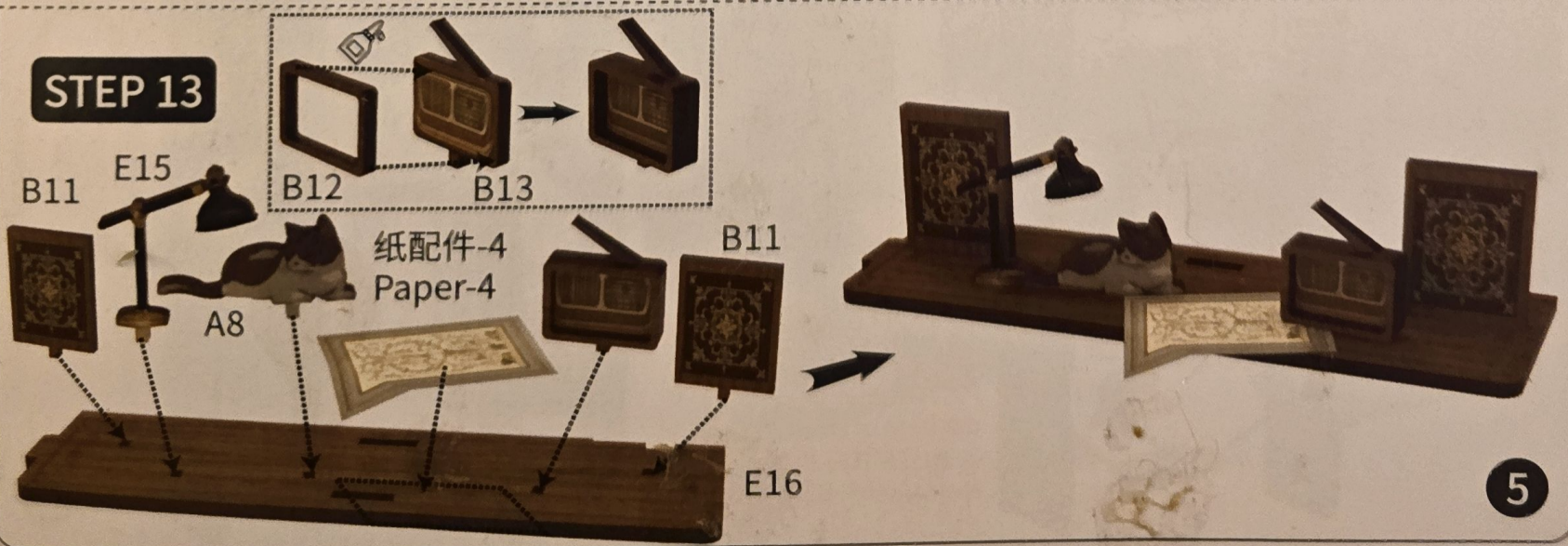

STEP 14

纸配件-3
Paper-3

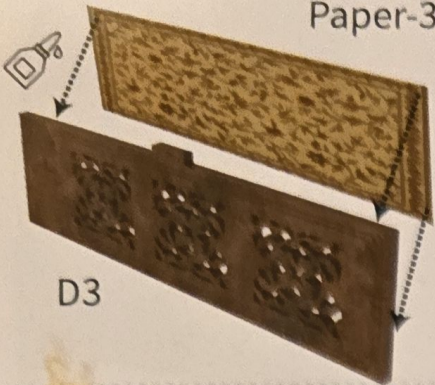

STEP 13

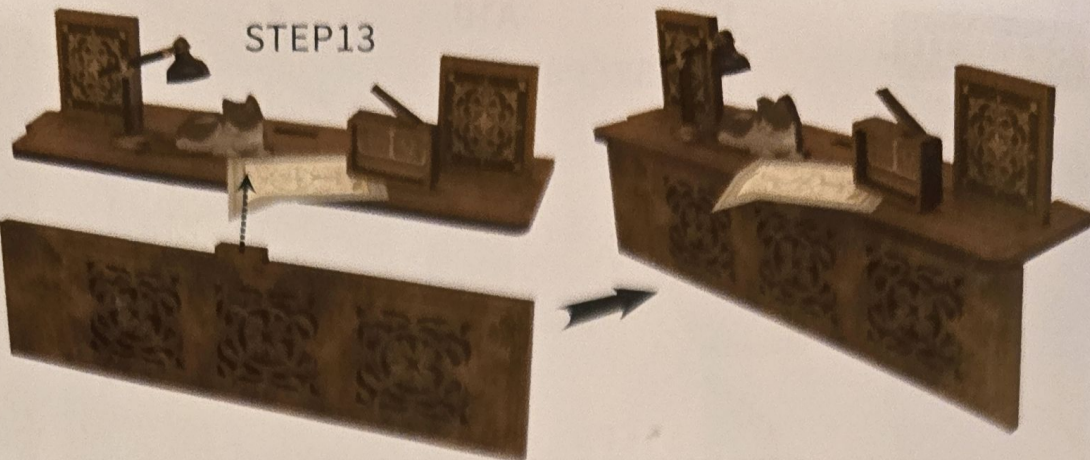

STEP 15

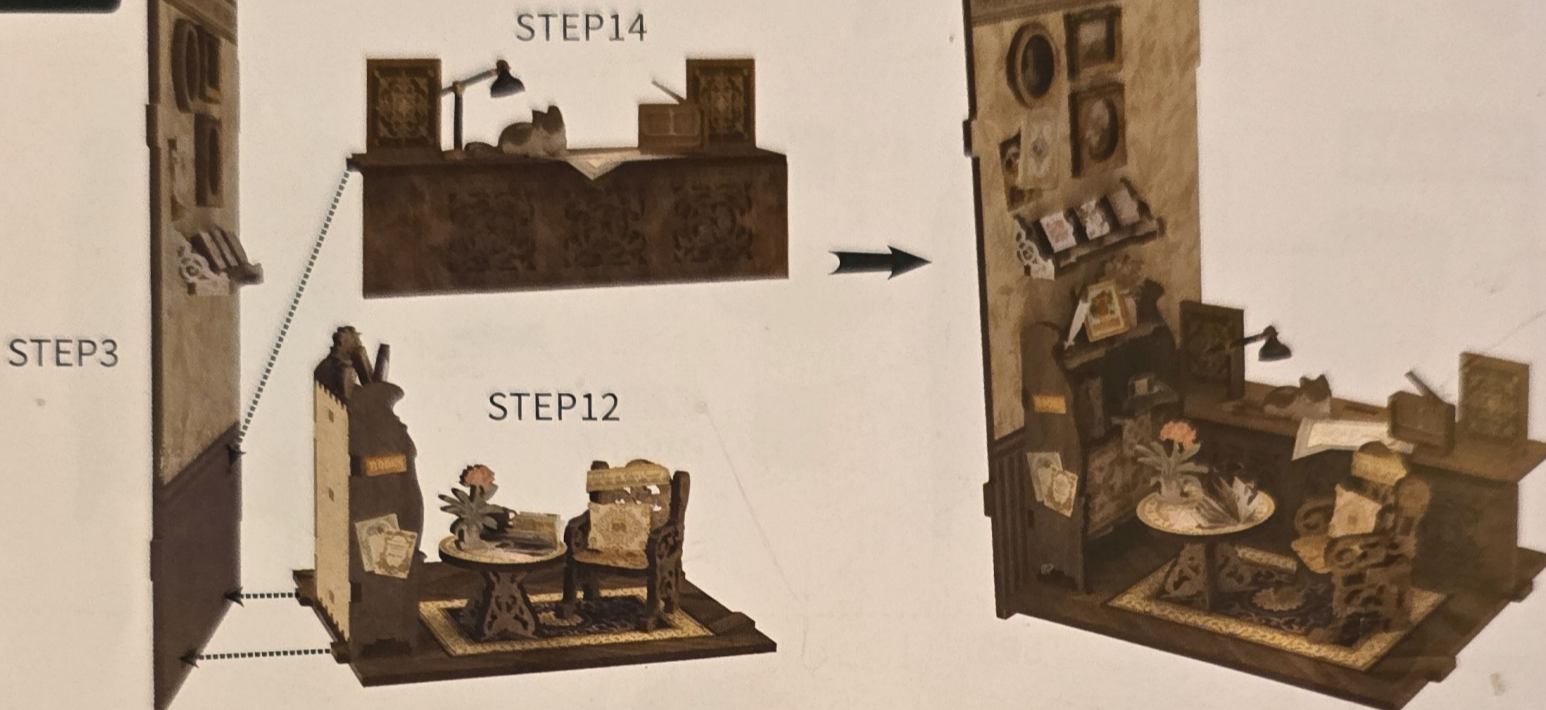

STEP 16

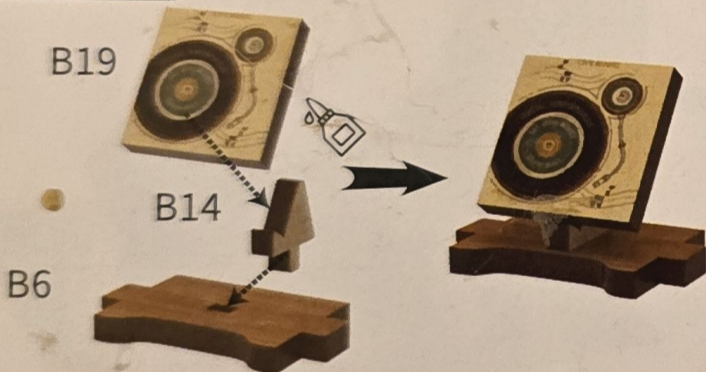

STEP 17

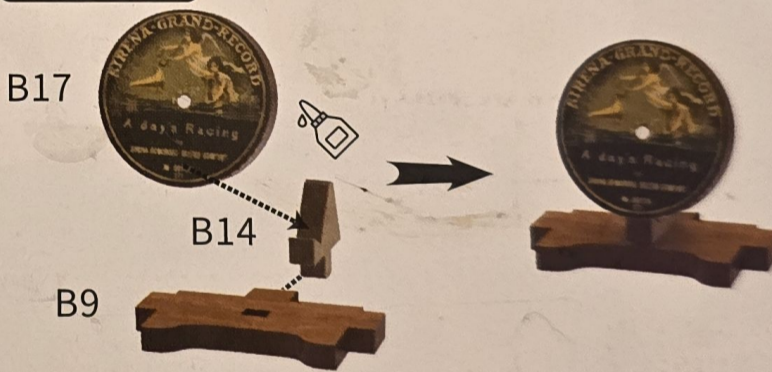

STEP 18

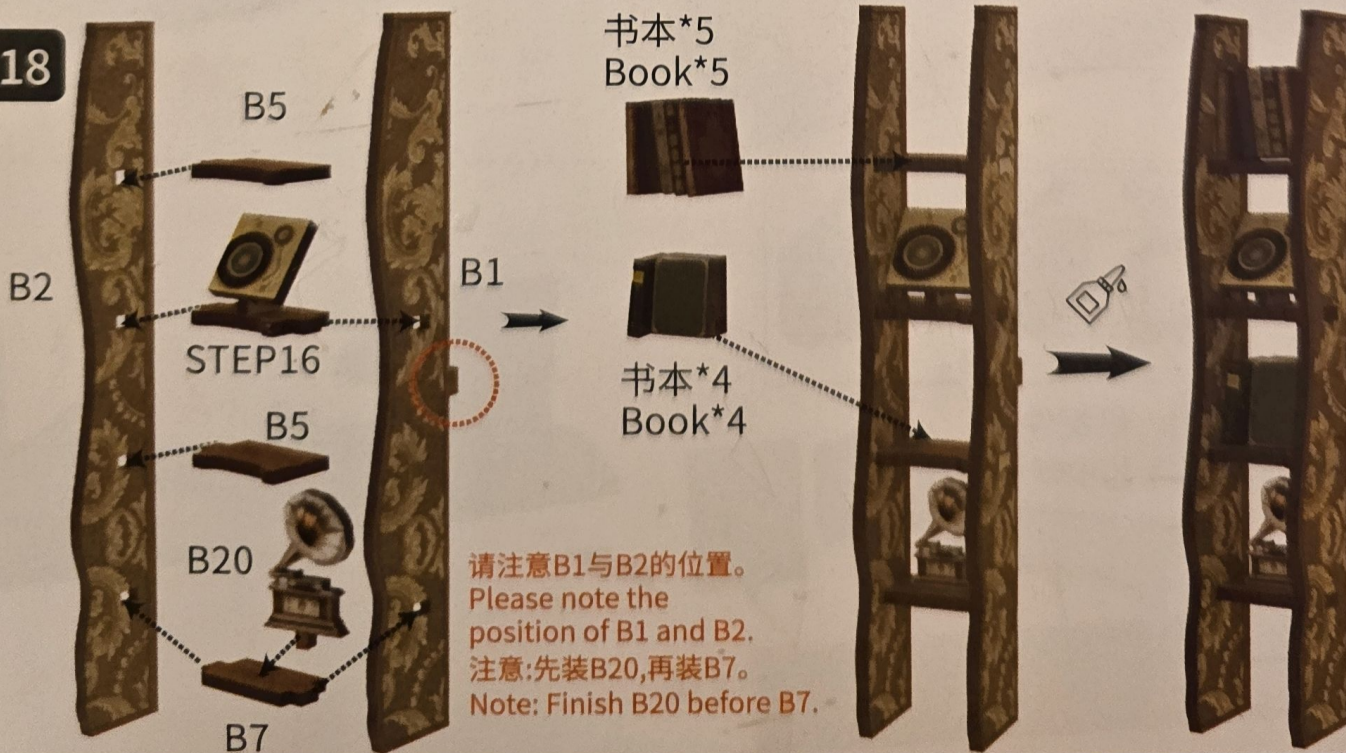

书本*5
Book*5

书本*4
Book*4

请注意B1与B2的位置。
Please note the position of B1 and B2.
注意:先装B20,再装B7。
Note: Finish B20 before B7.

STEP 19

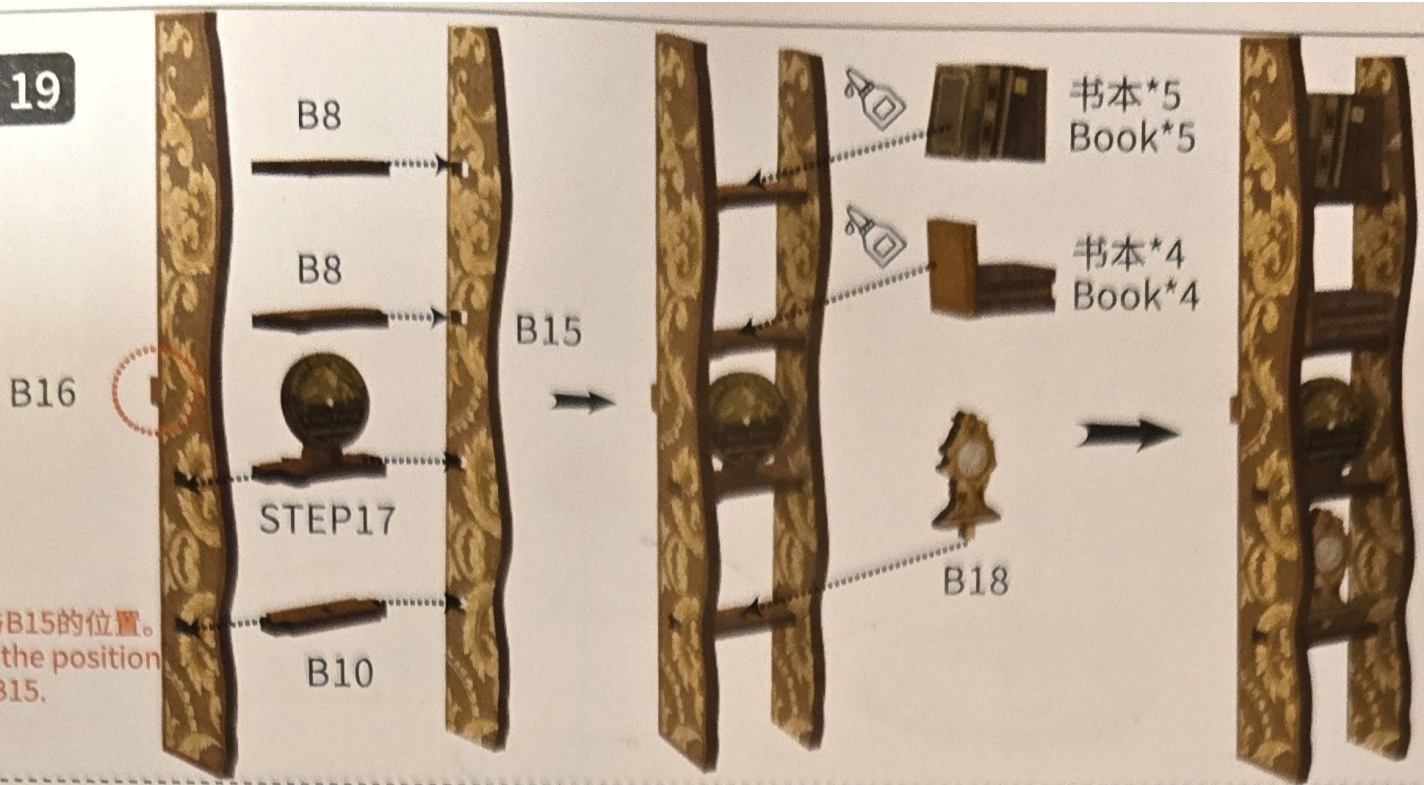

请注意B16与B15的位置。
Please note the position
of B16 and B15.

STEP 20

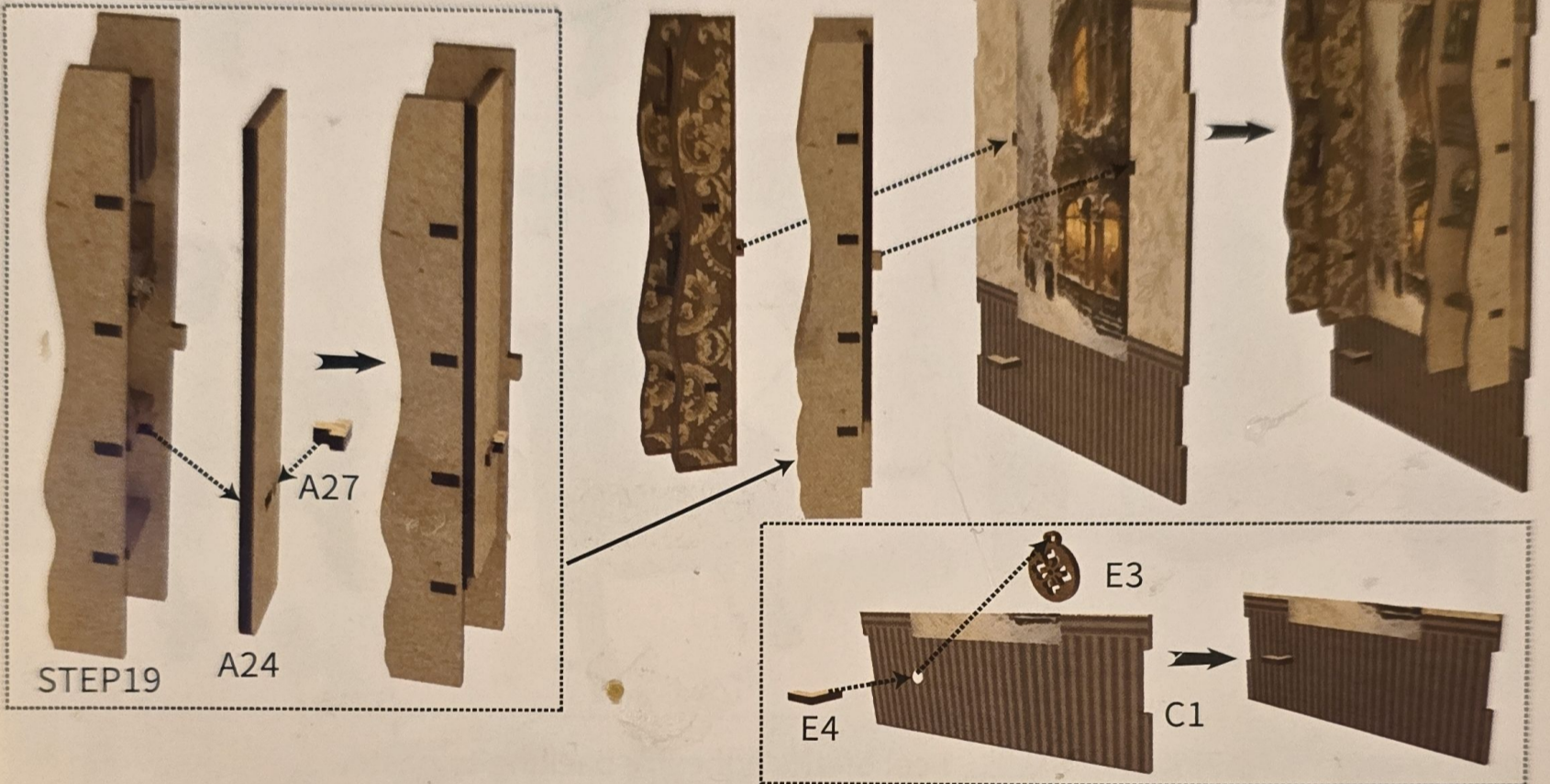

STEP 21



STEP15

注意:首先安装STEP 20。
Note: Finish STEP20.

STEP 22

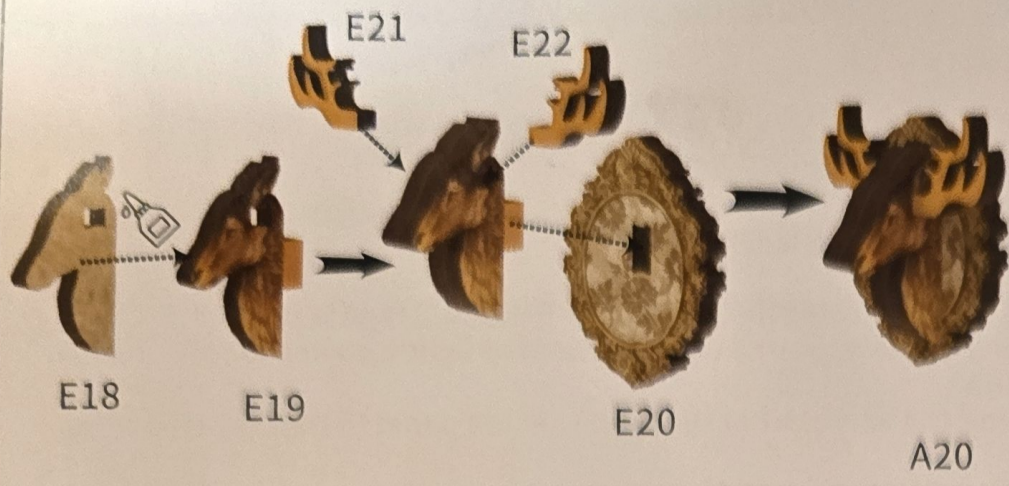

STEP 23

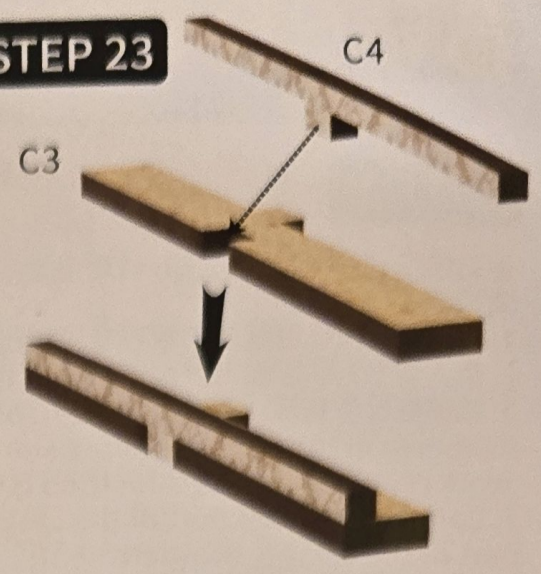

STEP 24

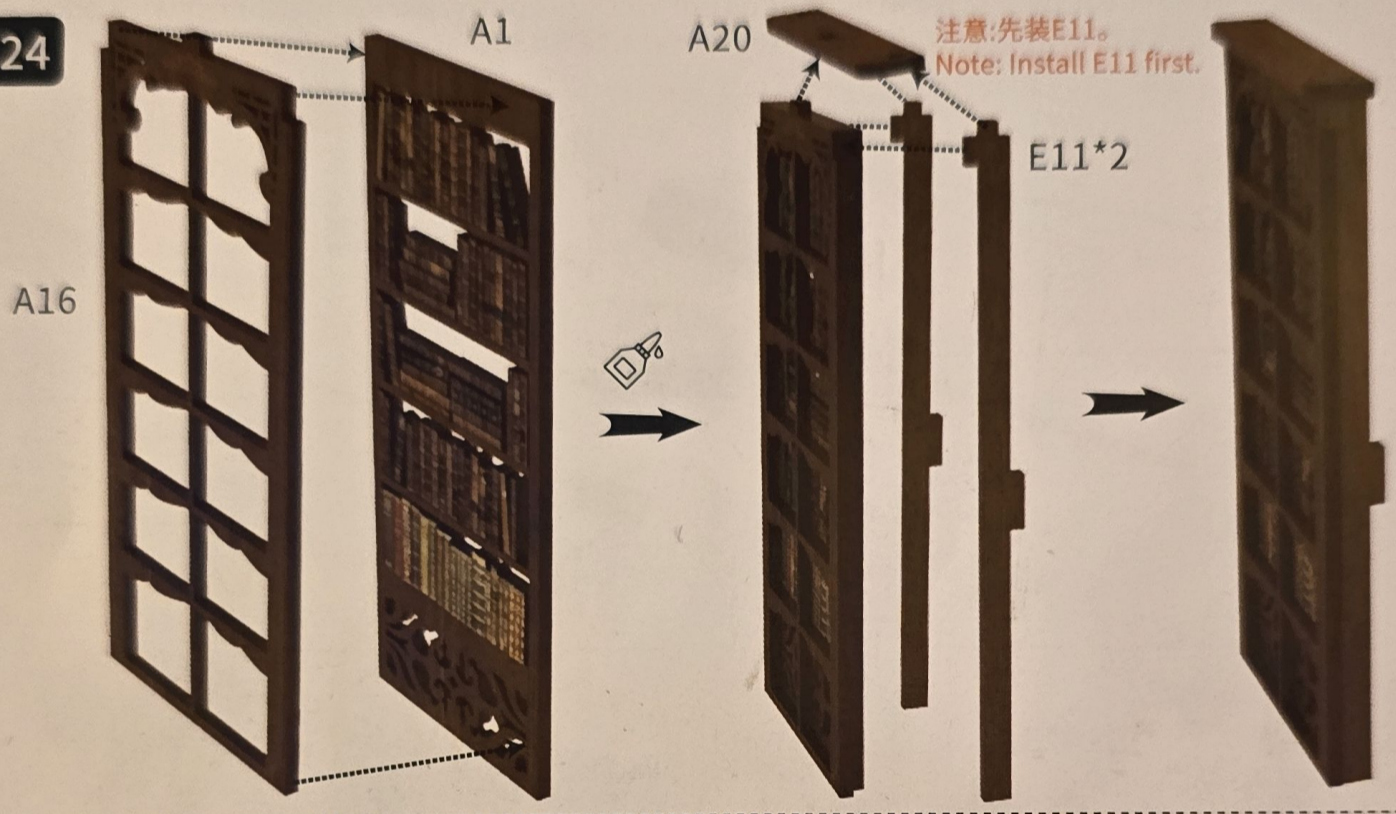

STEP 25

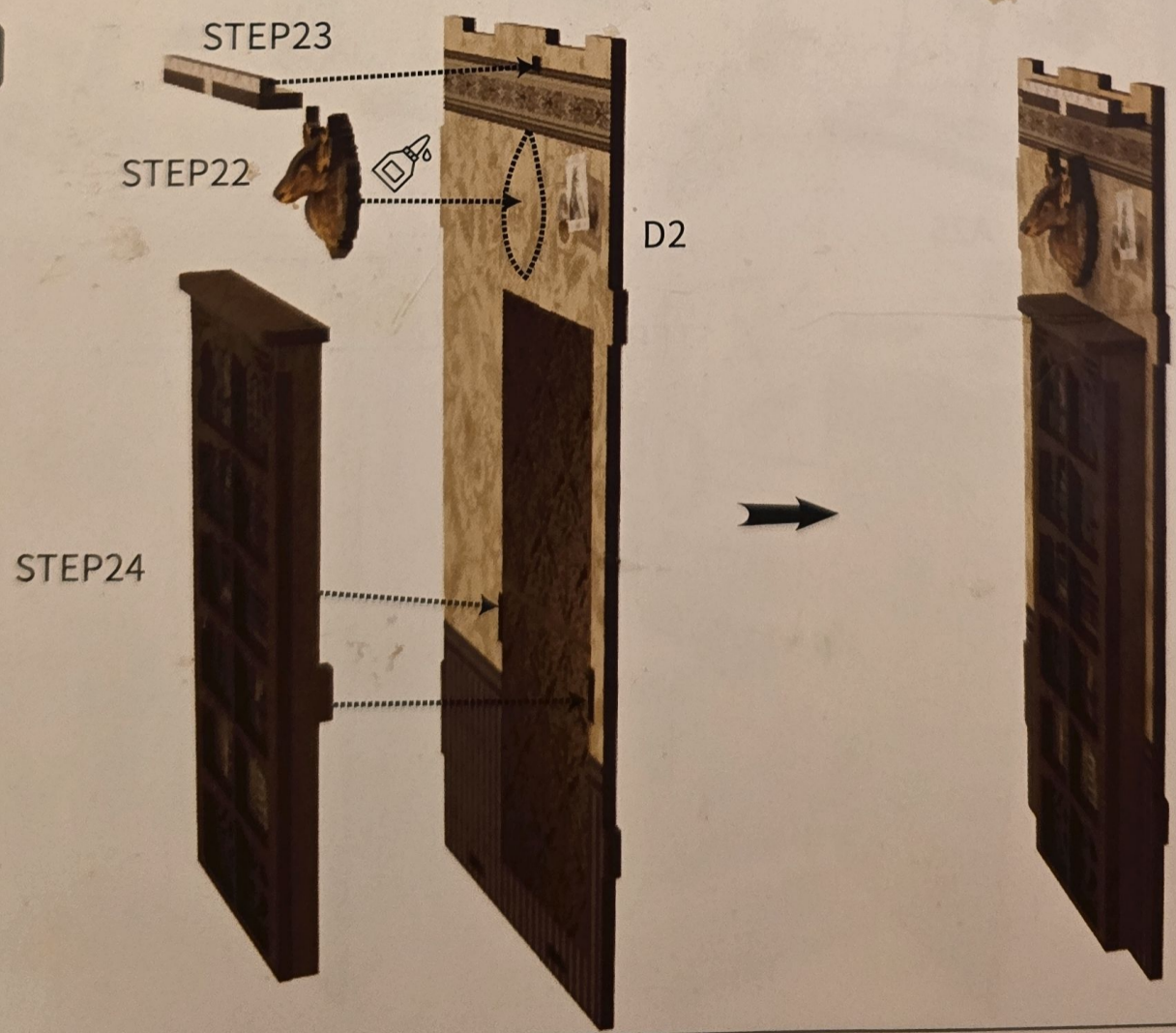

STEP 26

STEP21

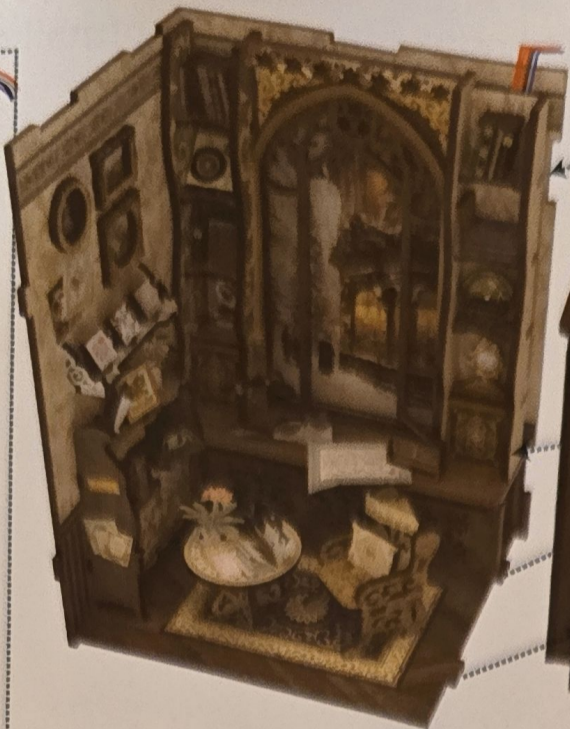

STEP25



LED 灯 LED Light*1
触摸线 Touch line*1

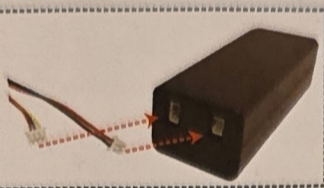

STEP 27

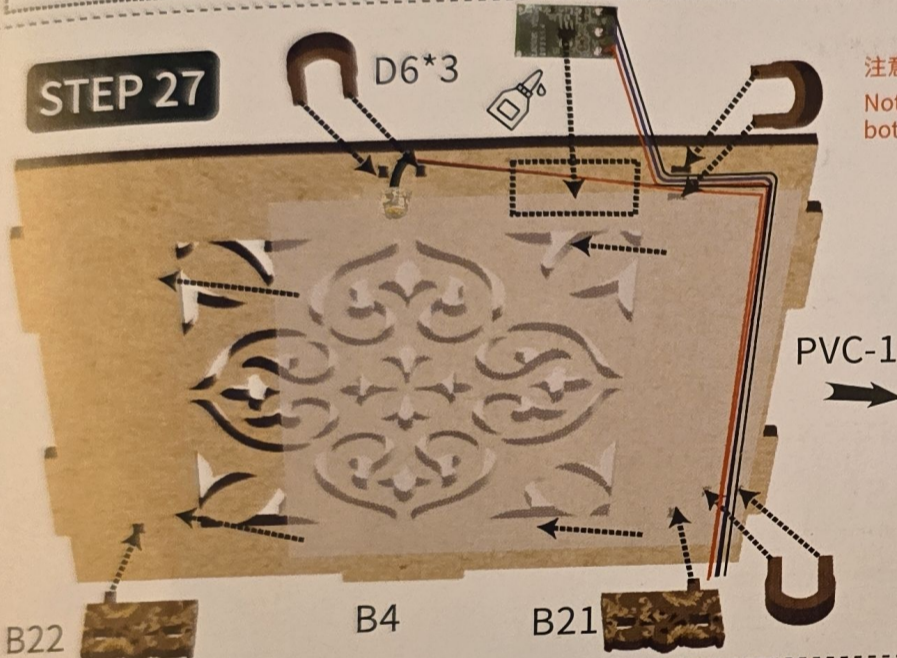

注意：撕开PVC两面的保护膜再粘贴。
Note: Tear the protective film on both sides of PVC before pasting.

将灯泡折成90度
Bend the bulb to 90degrees

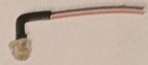

STEP 28



STEP27



注意：灯线轻轻拉，边拉边整理灯线，最后安装顶板。
Note: Gently straighten the lamp wire, arrange the lamp wire while pulling, and finally install the top plate.



STEP26

STEP 29

注意：撕开PVC两面的保护膜再粘贴。
Note: Tear the protective film on both sides of PVC before pasting.

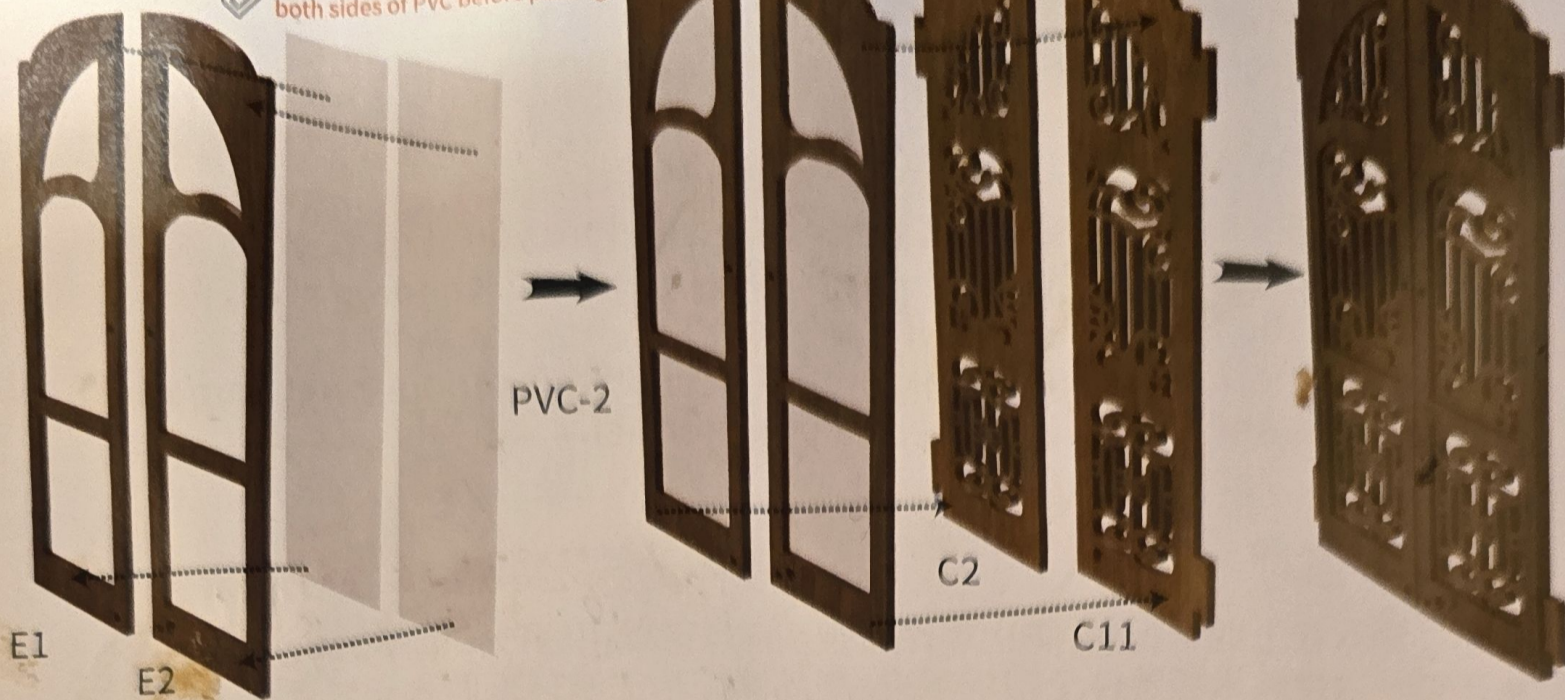

STEP 30

STEP29

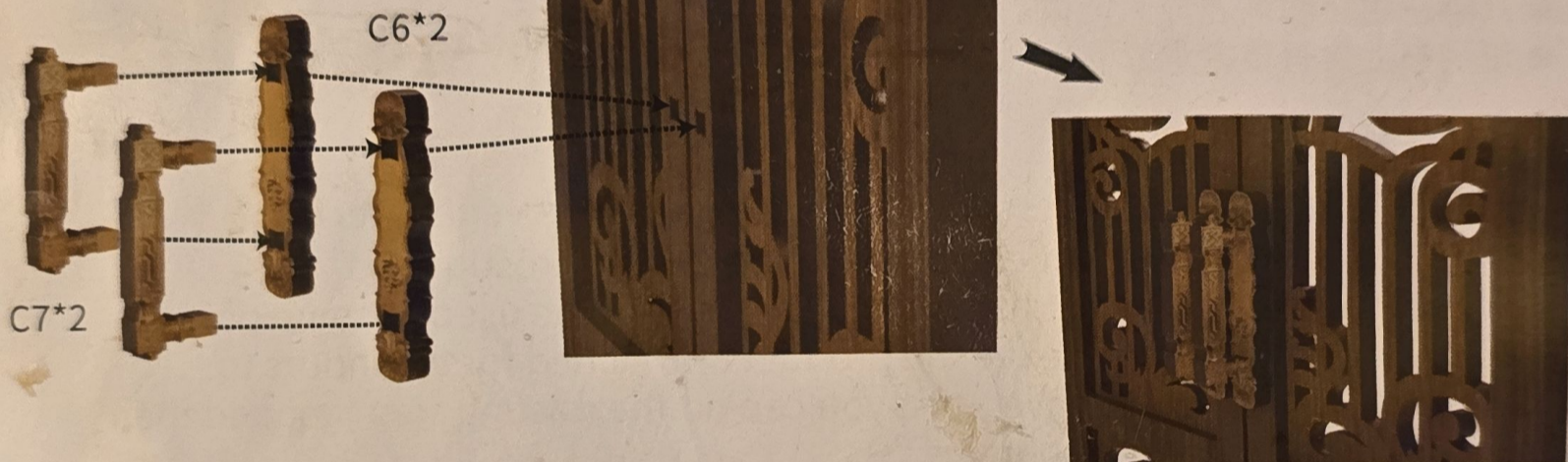

STEP 31

STEP30

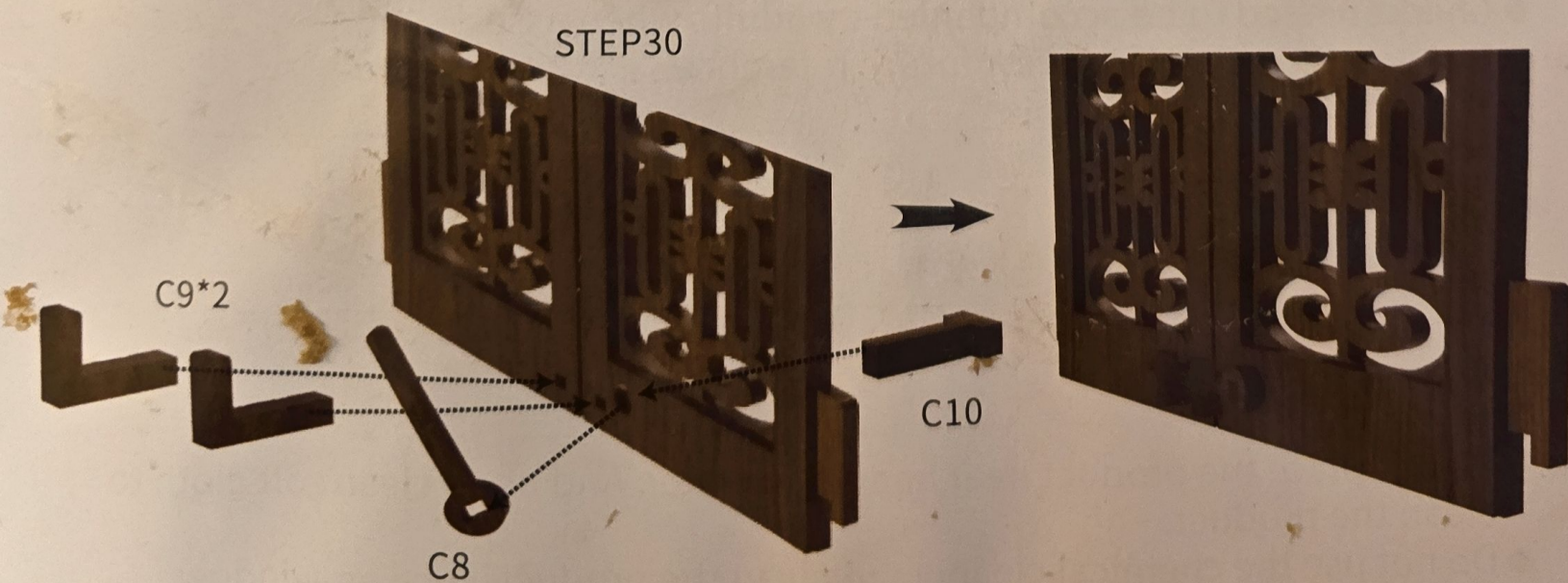

STEP 32

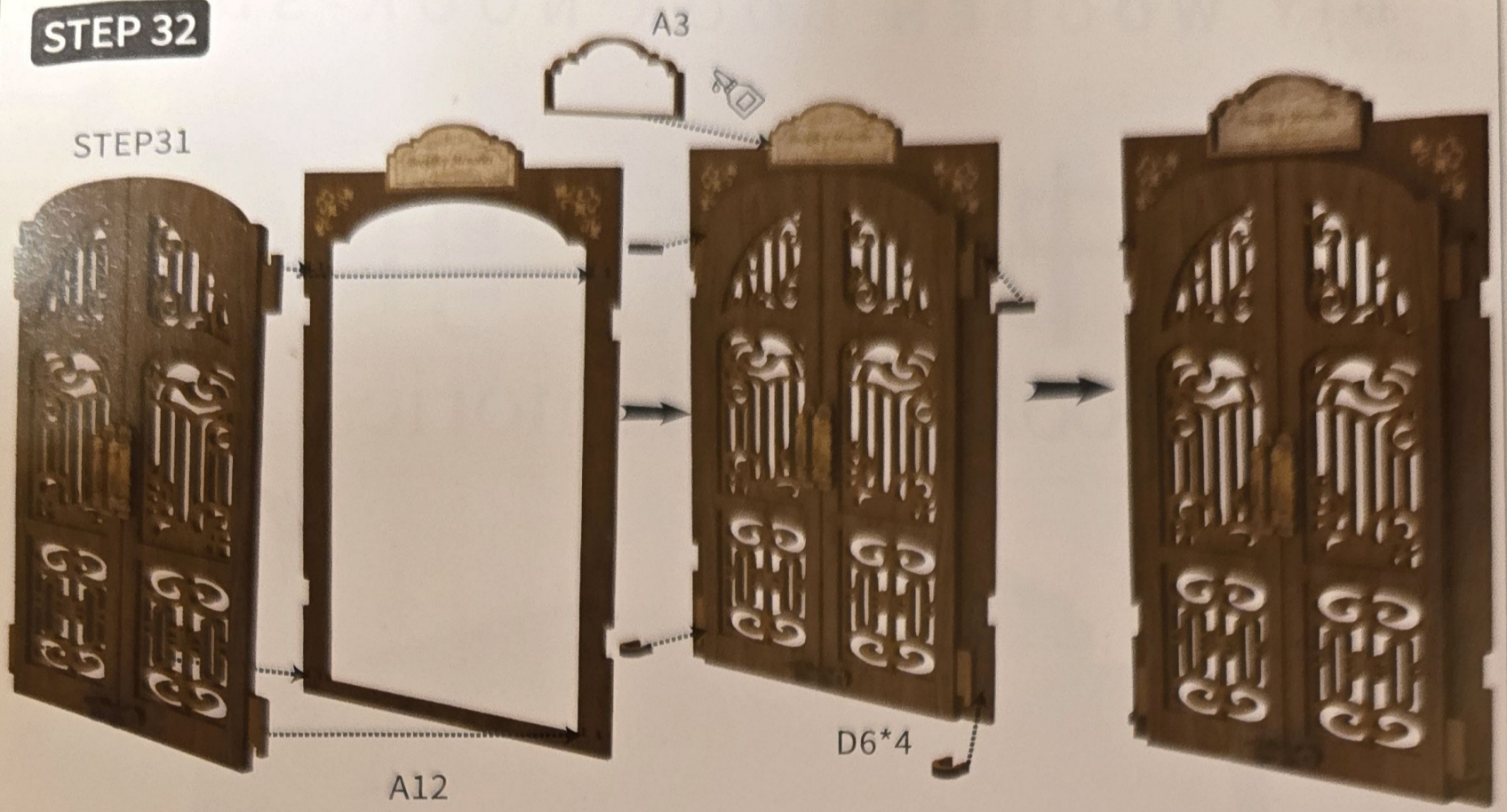

STEP 33



完成!将2节7号电池放入电池盒中,按下触摸面板,即可开灯。
Put 2 AAA batteries into the battery box,press the touch panel to turn on the light.